

Introducing our **Animal Proof Litter Receptacle**



...keep
Litter
where it
Belongs!

Double Unit: BPLR2
130 Gal. (500 litres) capacity or two 35" x 50" Garbage Bags

- Bear resistant latches on both lids and doors.
- Laterally opening, lockable rear door. (padlocks not included)
- Available in a full range of colours.
- Self closing and weather proof lids.
- Slide-out trash bag support mechanism for easy removal and replacement of bags.
- Modular replacement parts available.
- Pre-galvanized steel construction.



Single Unit: BPLR1
70 Gal. (260 litres) capacity
or a 35" x 50" Garbage Bag

paris
EQUIPMENT MANUFACTURING LTD.

**Paris Equipment
Manufacturing Ltd.**

Toll Free: 1-800-387-6318
sales@peml.com
www.peml.com

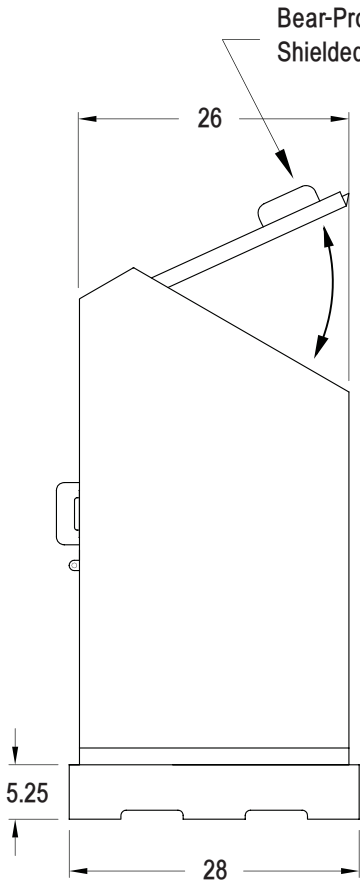

Typical Side View

Single Unit
Model: BPLR1
Min. Capacity: 260 Litres

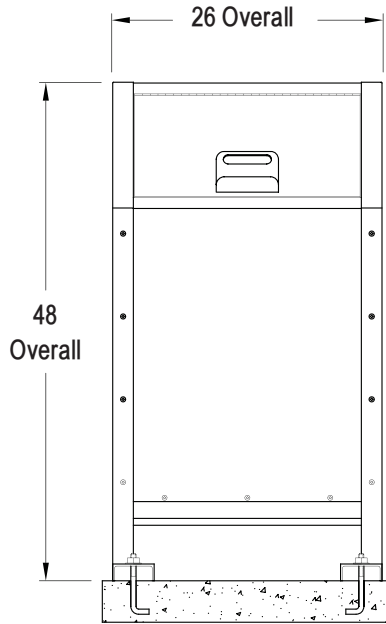

Front View

Double Unit
Model: BPLR2
Min. Capacity: 500 Litres

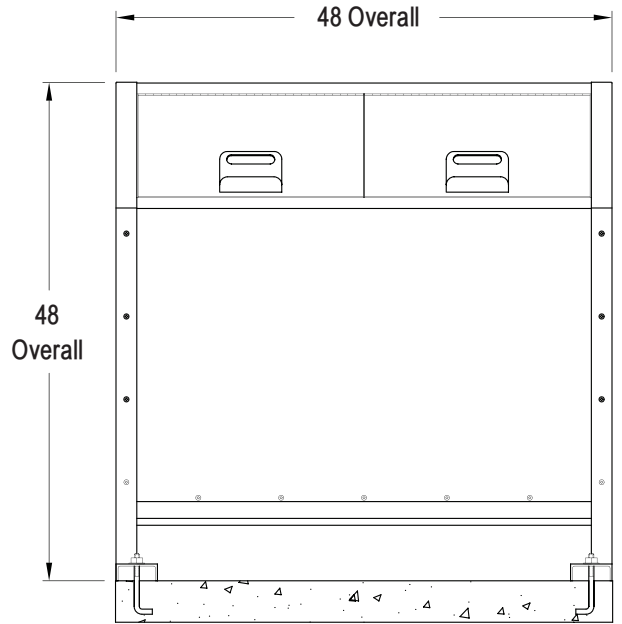

Front View

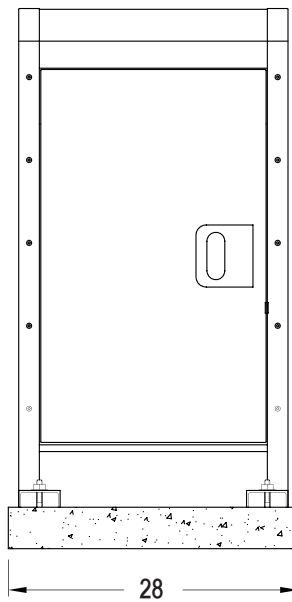

Rear View

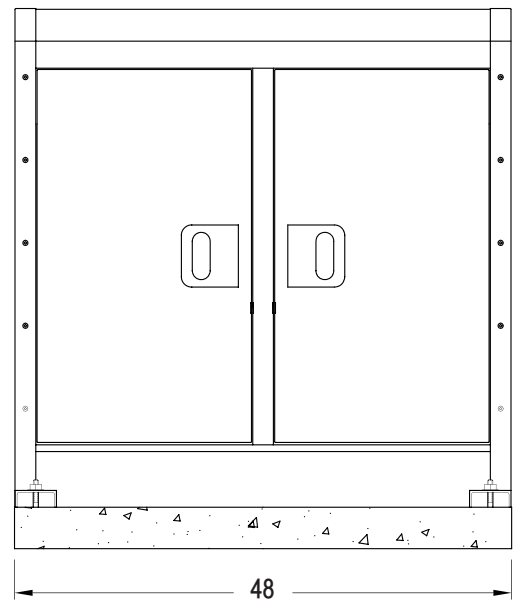

Rear View

Animal Proof Litter Receptacles